

Stop Runaway Accidents!

Three Solutions:

- **IRB** - Ican Rail Brake
- **IWB** - Ican Wheel Brake
- **IAB** - Ican e•Access Brake



IRB - Rail Brake

*over 200 units installed worldwide

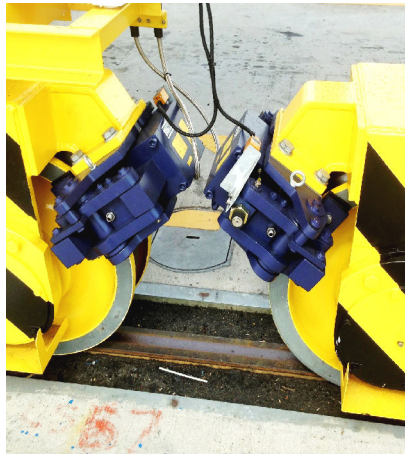

IWB - Wheel Brake

*over 1500 units installed worldwide



IAB - easy Access Brake

*5000 units installed worldwide



IAB - easy Access Brake

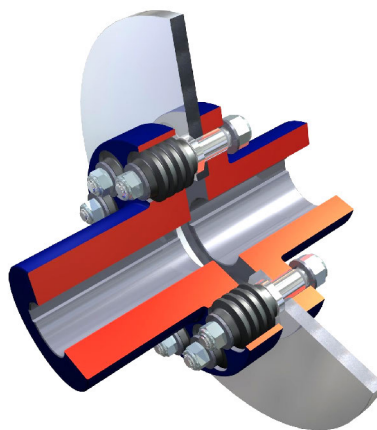

I-FLEX coupling
(Oil-free dry type)

Due to recent sudden wind gusts, container cranes break loose and many collision and collapse accidents have occurred.

Ican's IRB, IWB and IAB's prevent cranes from running away and dramatically improve the safety factor.

We additionally provide brake overhaul services to maintain safety.
See our website for more details and information.



Ican Company Ltd.

1-1-5, SHINTOMI, CHUO-KU, TOKYO 104-0041 JAPAN
TEL +81-3-3552-7781 FAX +81-3-3555-0681
<http://www.ican.co.jp>

Stop Runaway Accidents!

Ican has been the leading manufacturer of crane brake in Japan. We are paying special attention to the increase of crane runaway accidents caused recently by irregular climates prevailing in the world.

The following three are our proposals which have been presented, installed and in operation at major container terminals all over the world.

Ican's Solutions:

1) The IRB (Ican Rail Brake):

- Efficient brake pad pressing rails hydraulically
- Dynamically and Statically both offering braking efficiency
- Crane running away can be stopped
- Over 200 units installed and operational worldwide

2) The IWB (Ican Wheel Brake):

May be installed in addition to existing running brake to increase overall total braking power

- Totally visual inspection provides easy maintenance
- Dynamical breaking also extremely efficient
- Does not clamp on rail like a rail clamp which have the potential to break
- Over 1500 units currently installed and operational world wide

3) The IAB (Ican eAccess Brake):

- Easy access provides easy visual inspection
- Easy access provides easy maintenance work
- Automatic brake centering and gap clearance adjusting system
- Over 5000 units currently installed and operational world wide

Safety measures:

Conventional running brakes are coupled to electric motors and are normally totally enclosed which makes visual inspection and maintenance very difficult. In addition, together with a great number of bolts, which require heavy handling and adjustments may cause a lack of attention to the brake pad wear down and eventually may lead to runaway accidents.

There exist several difficult points in addition to the above on the conventional installation of brakes for hoisting, topping and traverse equipments of container cranes as well. Namely the gear coupling between winch and electric motor needs to be regularly greased and the grease may be thrown from the gears onto the brake disc and brake lining nearby causing a gradual deterioration in braking performance.

Hence, Ican offers a dry-type coupling called the I-Flex Coupling. The I-Flex Coupling required no greasing as conventional gear coupling do and have very good records of service worldwide.

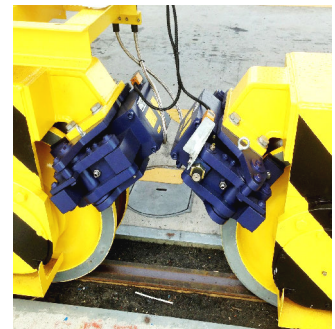

Ican Company Ltd.

1-1-5, SHINTOMI, CHUO-KU, TOKYO 104-0041 JAPAN
TEL +81-3-3552-7781 FAX +81-3-3555-0681
<http://www.ican.co.jp>